



New Arena at Seattle Center & NODO Mobility Action Program

Seattle Bicycle Advisory Board (SBAB)



City of Seattle

SDOT Vision, Mission, and Core Values

Vision: Seattle is a thriving equitable community powered by dependable transportation

Mission: to deliver a transportation system that provides safe and affordable access to places and opportunities

Committed to **6 core values:**

- Equity
- Safety
- Mobility
- Sustainability
- Livability
- Excellence

Presentation / Workshop Overview

1. NODO MAP: 1st Ave / Denny Way to 2nd Ave / Broad St PBL connection
2. NODO MAP: Seattle Center to Waterfront NGW and Thomas St Overpass
3. New Arena at Seattle Center:
 - a. 1st Ave N and Queen Anne Ave N
 - b. Thomas St between 1st Ave N and Queen Anne Ave N
 - c. 2nd Ave and Denny Way intersection
 - d. Review PBL connection at Queen Anne Ave N between Roy and Mercer St***
4. Questions / comments

**** = conceptual design, not included with arena street improvement plans*

NODO Mobility Action Program Map



1st Ave / Denny Way to 2nd Ave / Broad St

Existing Conditions

Per Key Arena Master Use Permit (MUP), a two-way PBL will come down the West side of 1st Ave N to Denny Way

High volume of vehicles (~150/hr) making WB to SB turn onto Warren Pl and connecting to 1st Ave

Western curb space = paid parking

Eastern curb space = Bus Only lane or paid parking

Northern curb space = Bus Only lane or paid parking

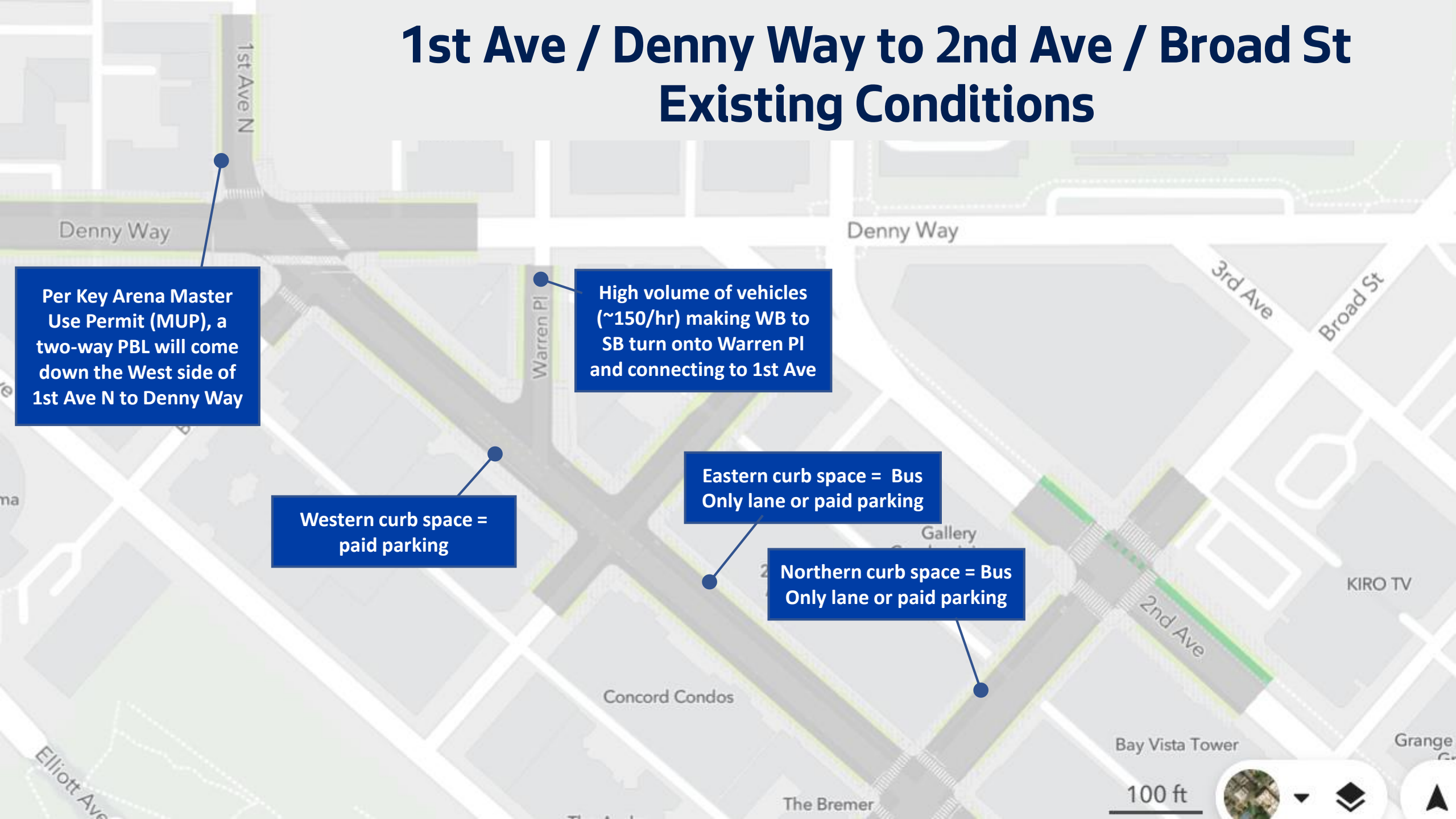

1st Ave / Denny Way to 2nd Ave / Broad St Proposed PBL Connection

Proposed West-leg
crosswalk

Denny Way

Trio Condos

Bay St

Conflict point
mitigation TBD;
considering vehicle
restrictions

Univera

Warren Pl

Matae Belltown
Condominiums

2900
Apartments

Existing curb bulb
to be removed

Conflict point
mitigation TBD;
considering vehicle
restrictions

2nd Ave

Bay Vista Tower

KIRO TV

Grange

The Bremer

The Audrey

100 ft



Thomas St Overpass and Seattle Center to Waterfront NGW

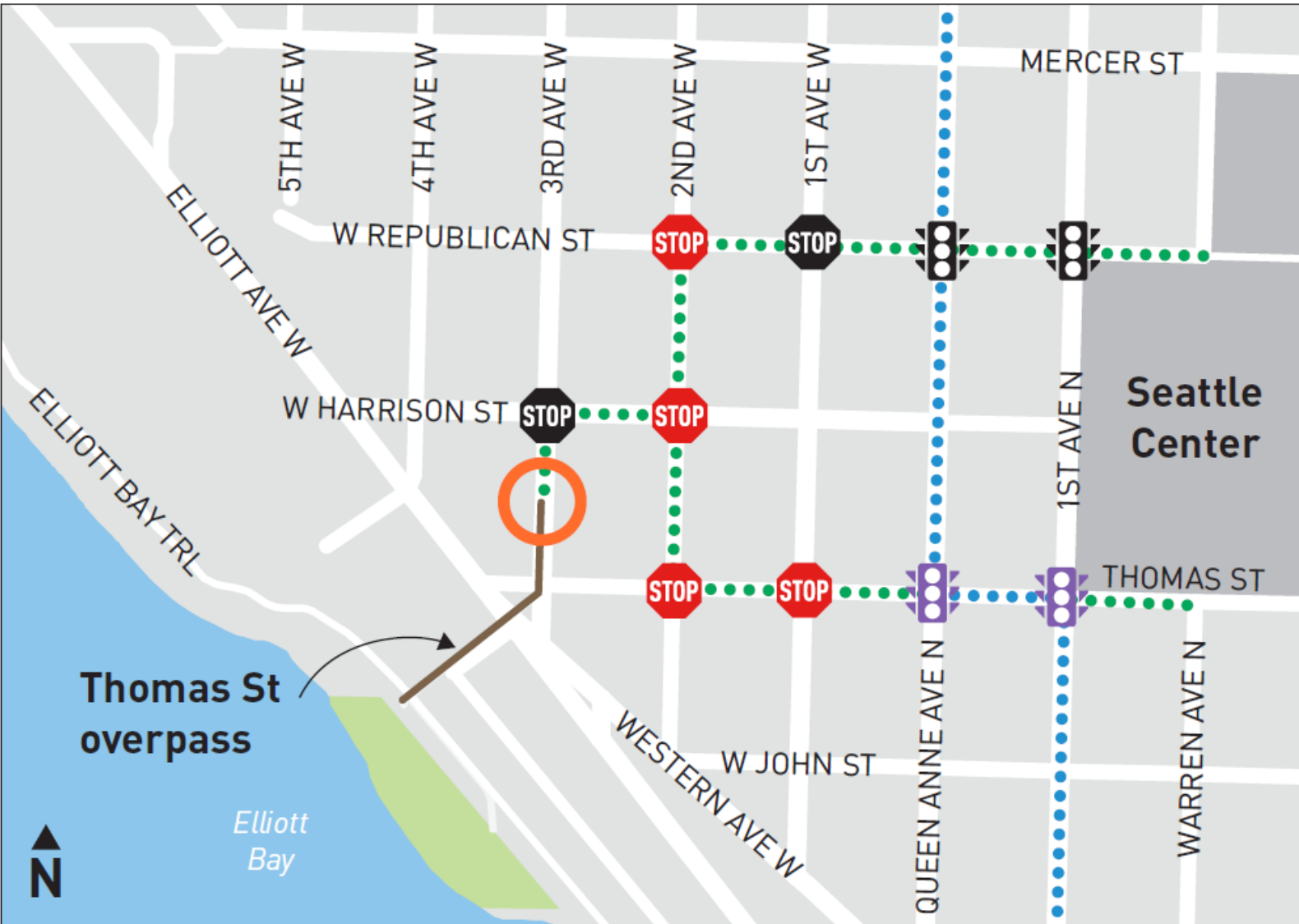

SEATTLE CENTER TO WATERFRONT NEIGHBORHOOD GREENWAY

Proposed Scope

- Planned Neighborhood Greenway (target year 2021)
- Planned bike lanes (target year 2021 - by others)
- Signal upgrades (by others)
- New signals (by others)
- Retained existing all-way stop
- New all-way stop
- Improved civil connection to the Thomas St Overpass

Thomas St Overpass and Seattle Center to Waterfront NGW

- Feedback from 12/4/19 SBAB: Extend existing loading zone west side of 3rd Ave W north of Thomas Street Overpass
- Opportunities for NGW connection to Thomas Street Overpass
 - 3 potential options
 - Online survey – now to 2/26/20
 - Drop-in session on 2/19/20
 - Details: <https://www.seattle.gov/transportation/projects-and-programs/programs/greenways-program/seattle-center-to-waterfront-greenway>

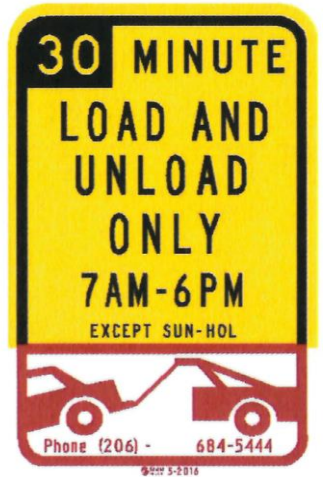

NGW Connection to Thomas St

Overpass Options

2/5/2020 Departm

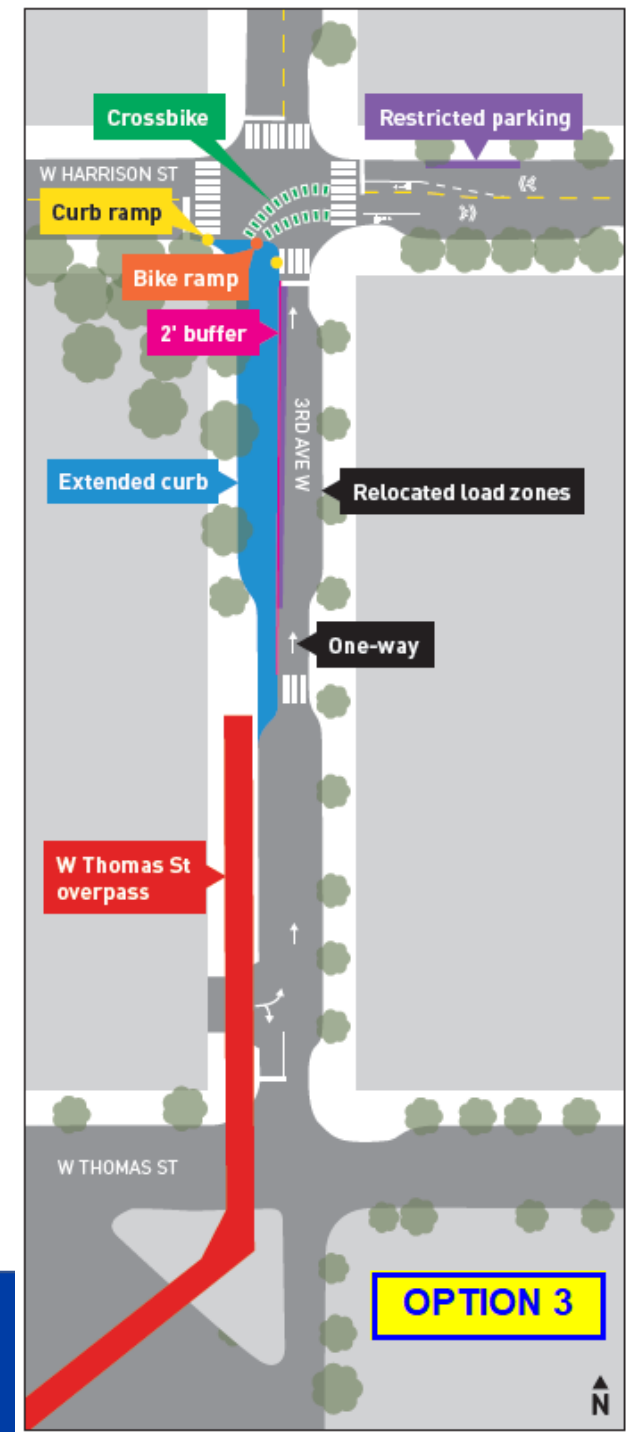
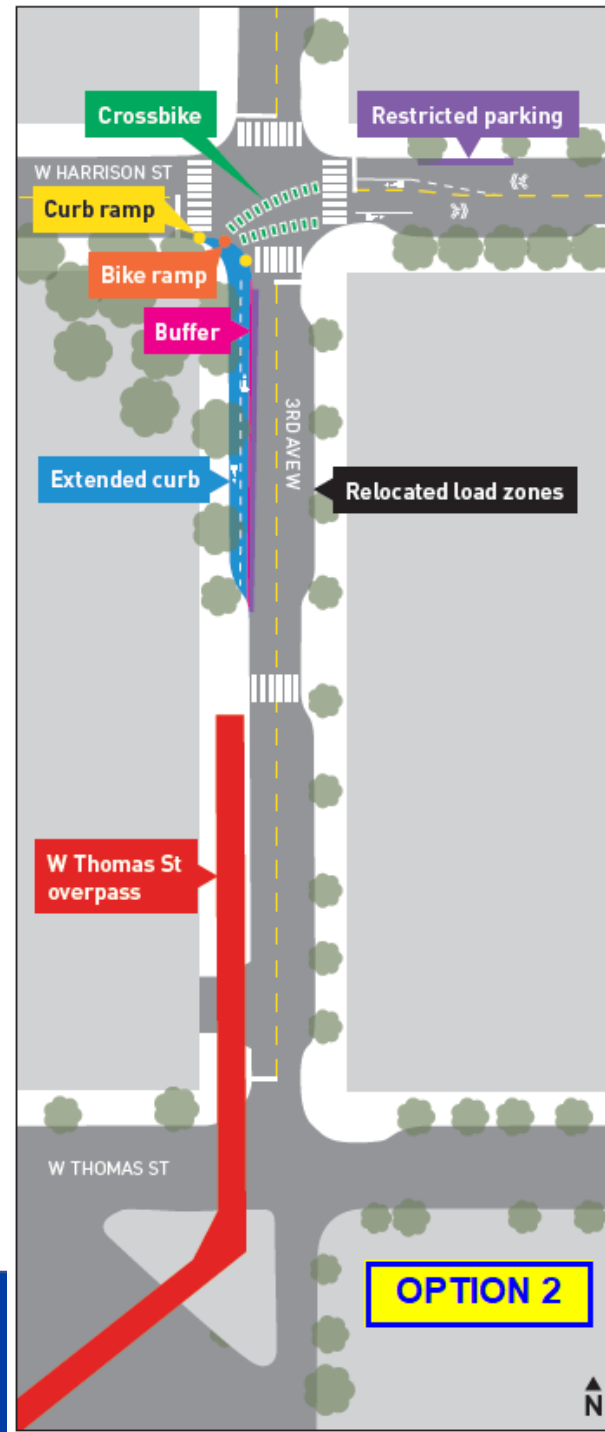
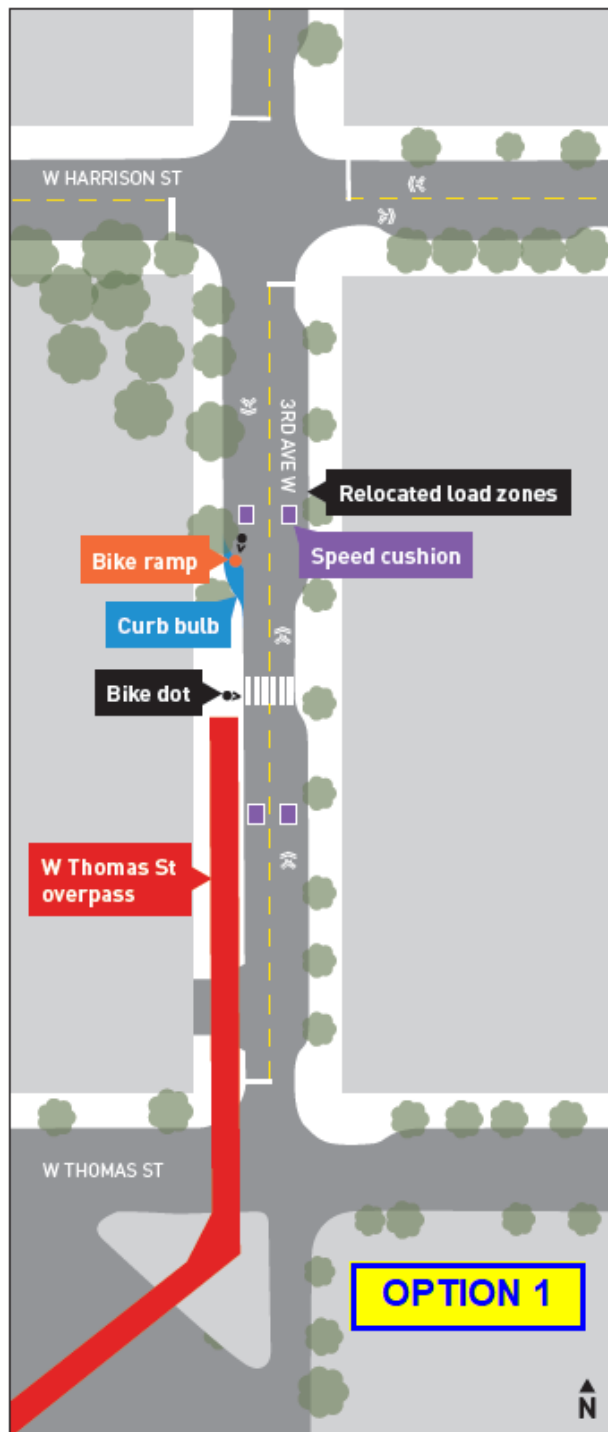

Arena Overview: Physical Improvements

We will talk through the improvements via Street Remix

<https://platform.remix.com/streets/plan/518a228e/scenario/d86f9176?latlng=47.61903,-122.35415,17.151>

1st Ave N and Queen Anne Ave N

- Two-way protected bike lane on the west side of 1st Ave N from Denny Way to Thomas St

(DRAFT, FOR DISCUSSION PURPOSES ONLY)

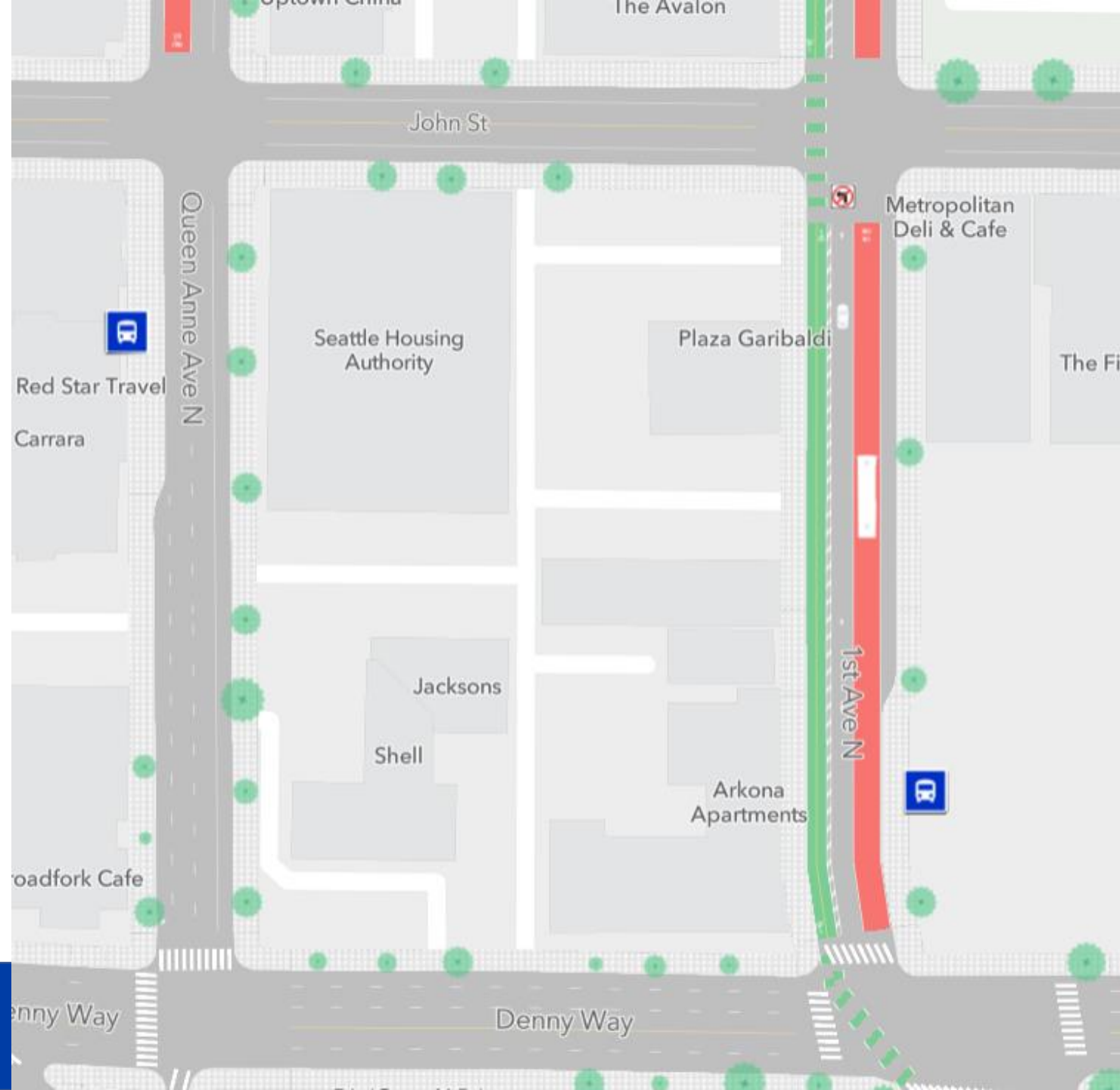

1st Ave N and Queen Anne Ave N

- Left turn restricted from 1st Ave N to John St and Thomas St
- New signals on Thomas St at 1st Ave N and Queen Anne Ave N

(DRAFT, FOR DISCUSSION PURPOSES ONLY)



1st Ave N and Queen Anne Ave N

- New curb bulbs on 1st Ave N & Harrison St
- Left turn restricted from Queen Anne Ave N to Harrison St
- Two-way protected bike lane on the east side of Queen Anne Ave N

(DRAFT, FOR DISCUSSION PURPOSES ONLY)

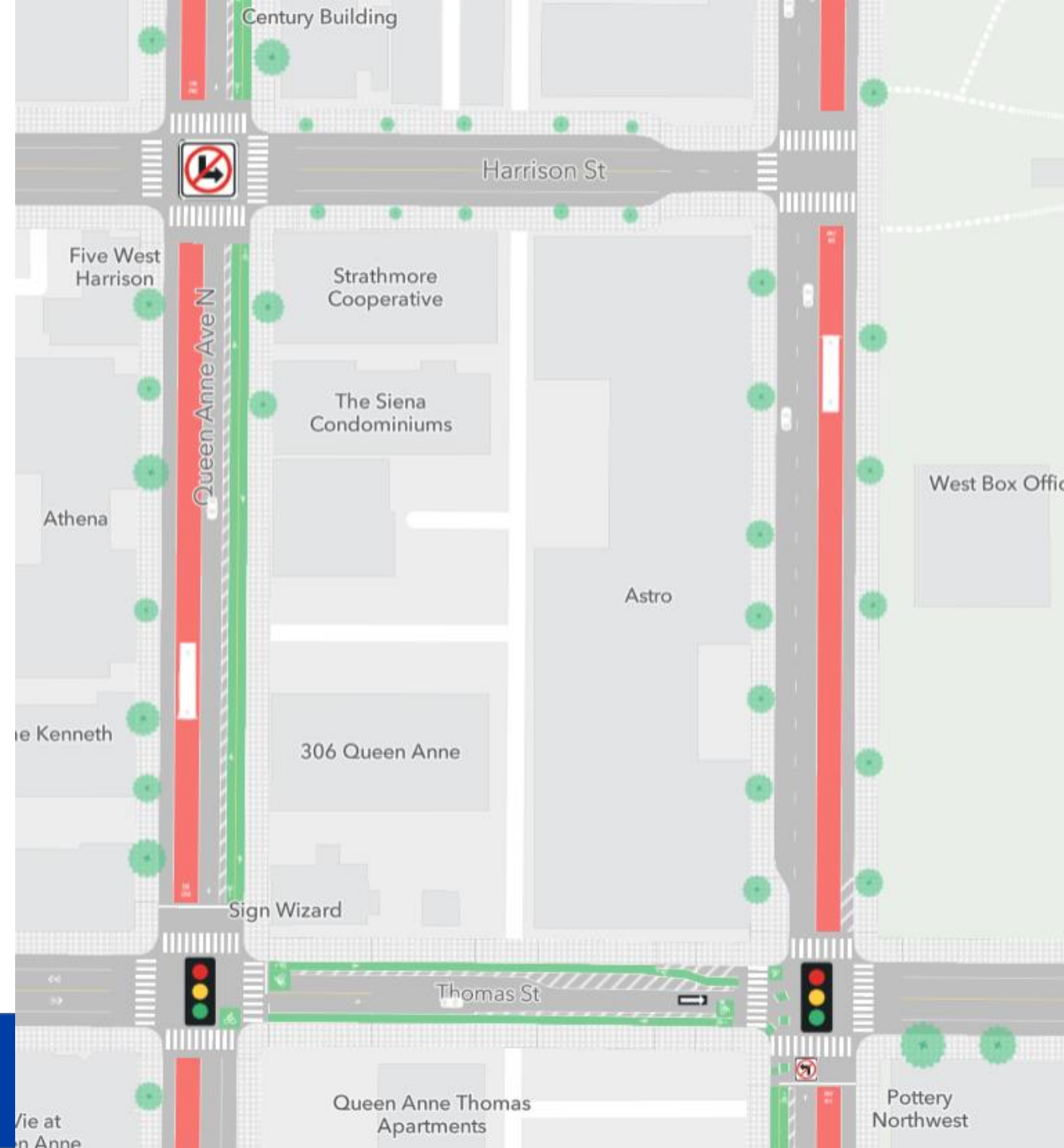

1st Ave N and Queen Anne Ave N

- New curb bulbs on Harrison St and Republican St on 1st Ave N
- Left turn restricted from Queen Anne Ave N to Republican St

(DRAFT, FOR DISCUSSION PURPOSES ONLY)

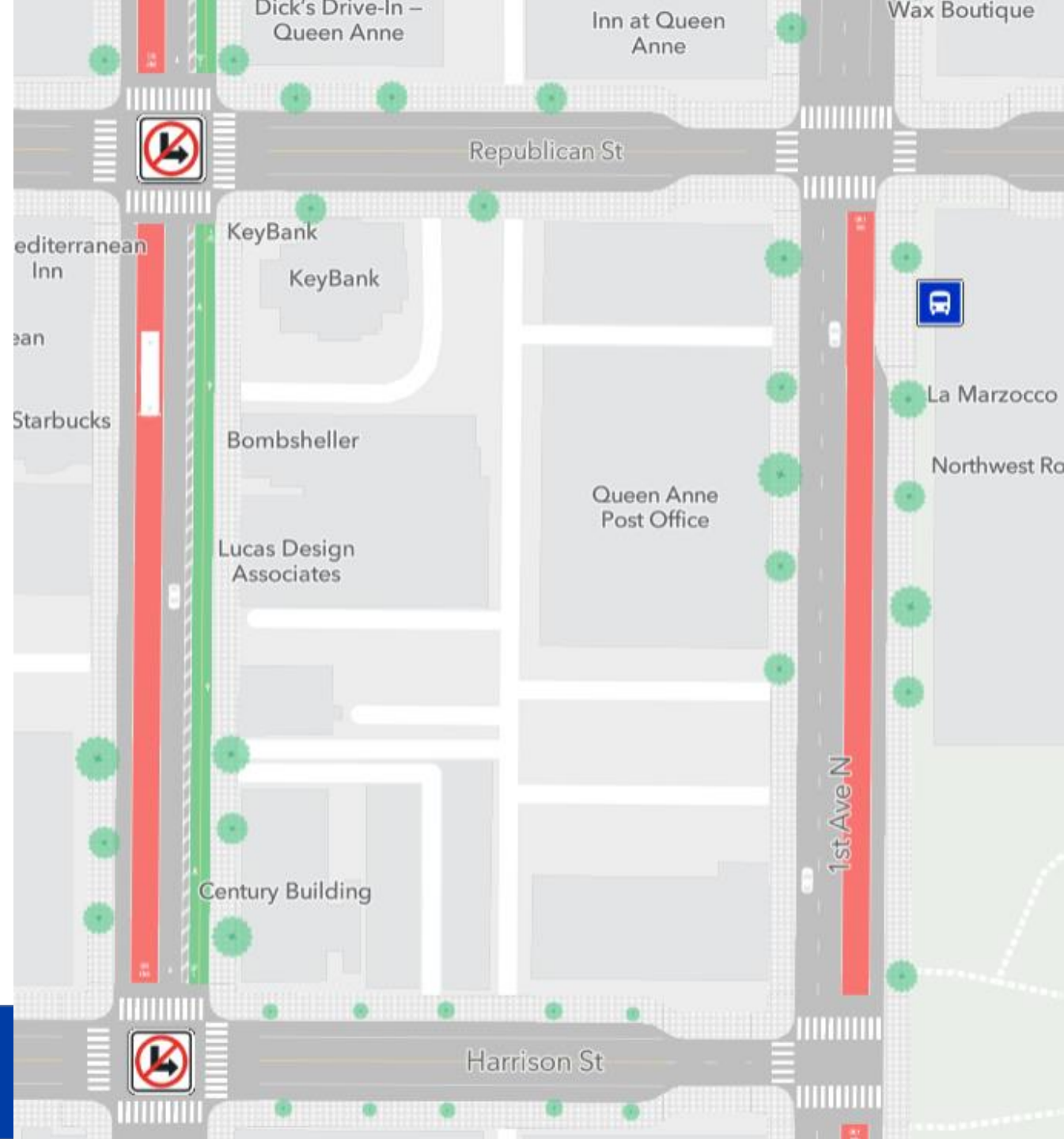

1st Ave N and Queen Anne Ave N

- Left turn restricted from Queen Anne Ave N to Republican St
- Removal of existing mid-block crossing north of Republican St

(DRAFT, FOR DISCUSSION PURPOSES ONLY)

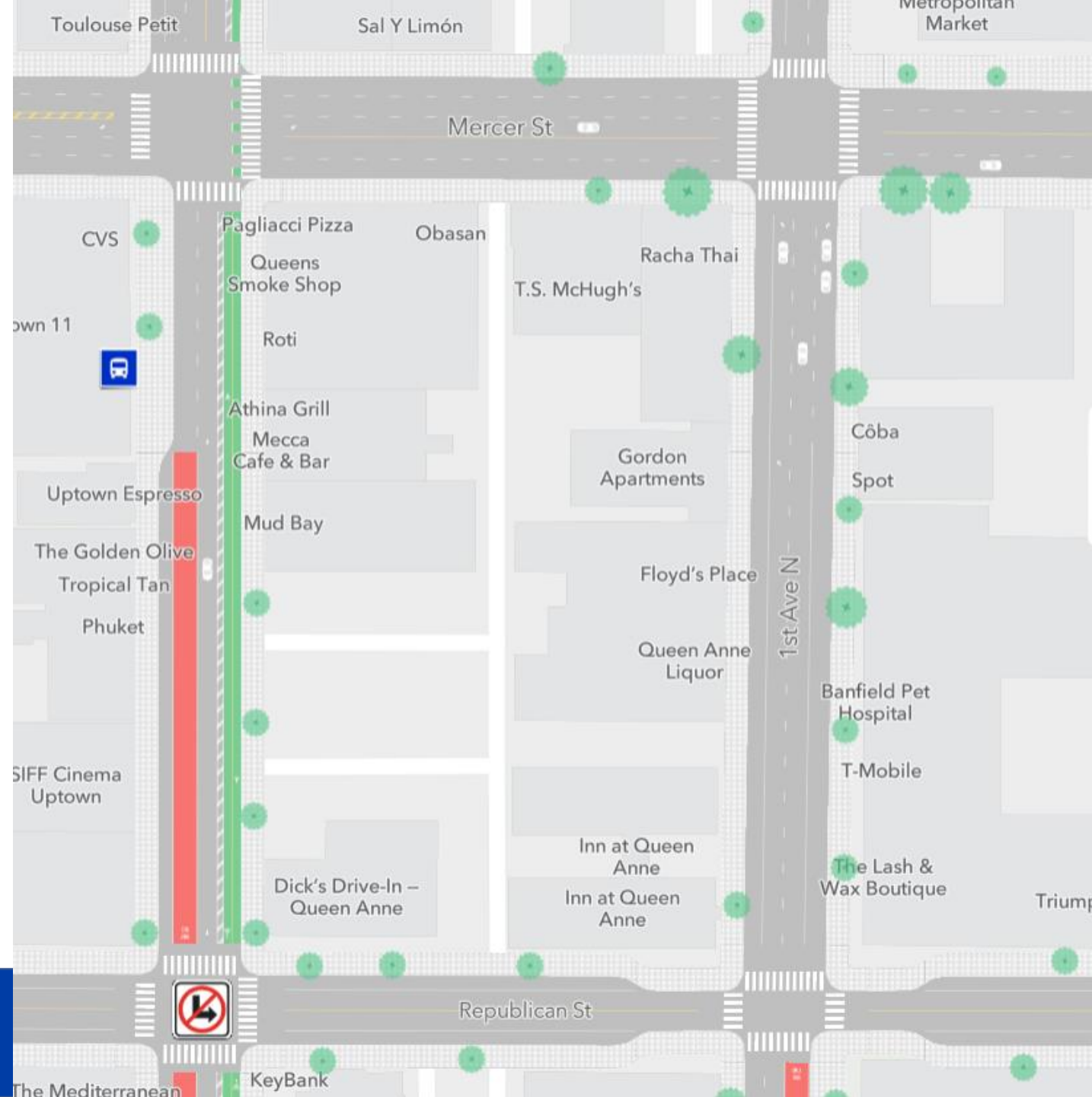

1st Ave N and Queen Anne Ave N

- Review PBL connection at Queen Anne Ave N between Roy and Mercer St***

*** = *conceptual design, not included with arena street improvement plans*

(DRAFT, FOR DISCUSSION PURPOSES ONLY)

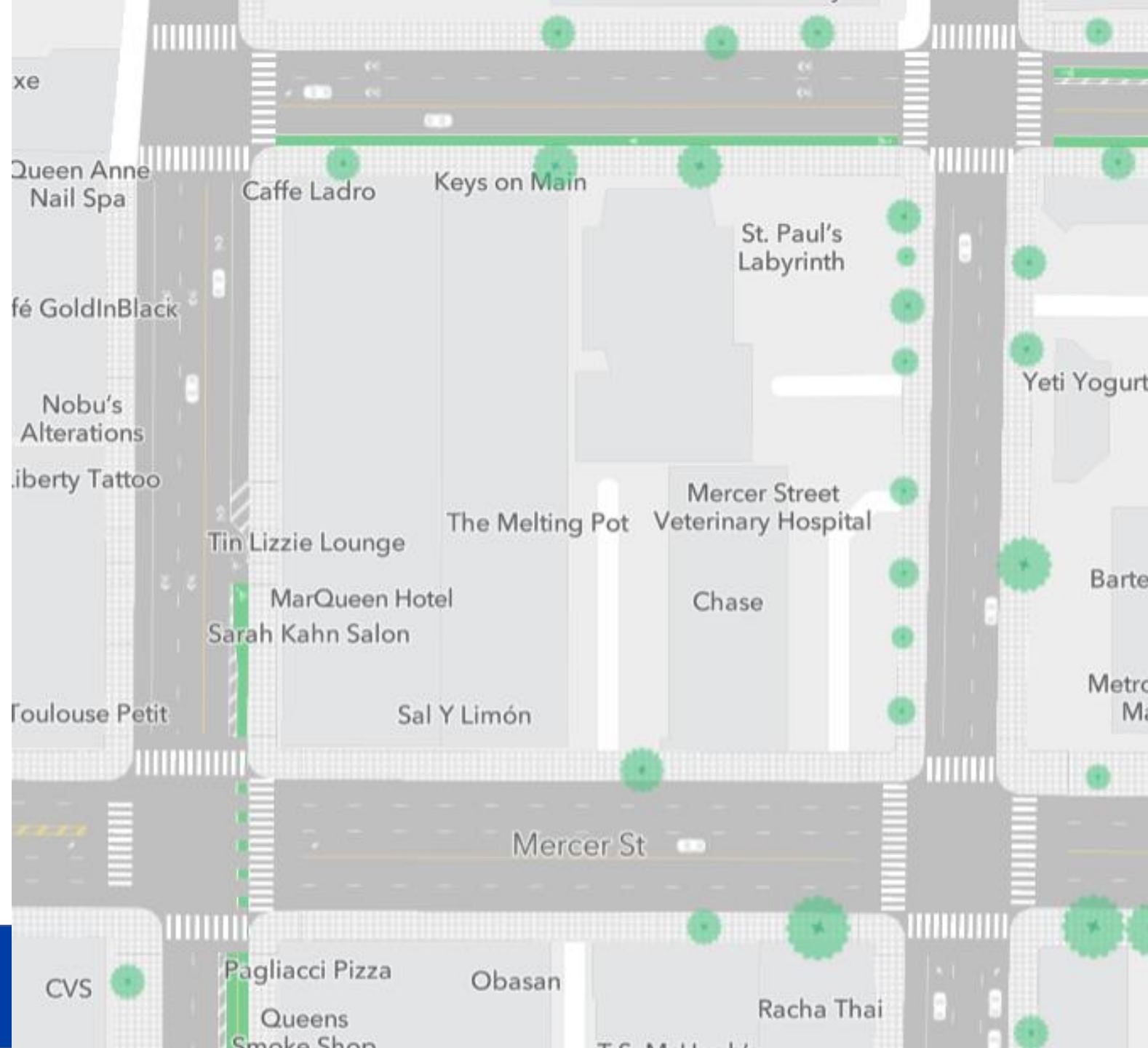

Thomas St between 1st Ave N and Queen Anne Ave N

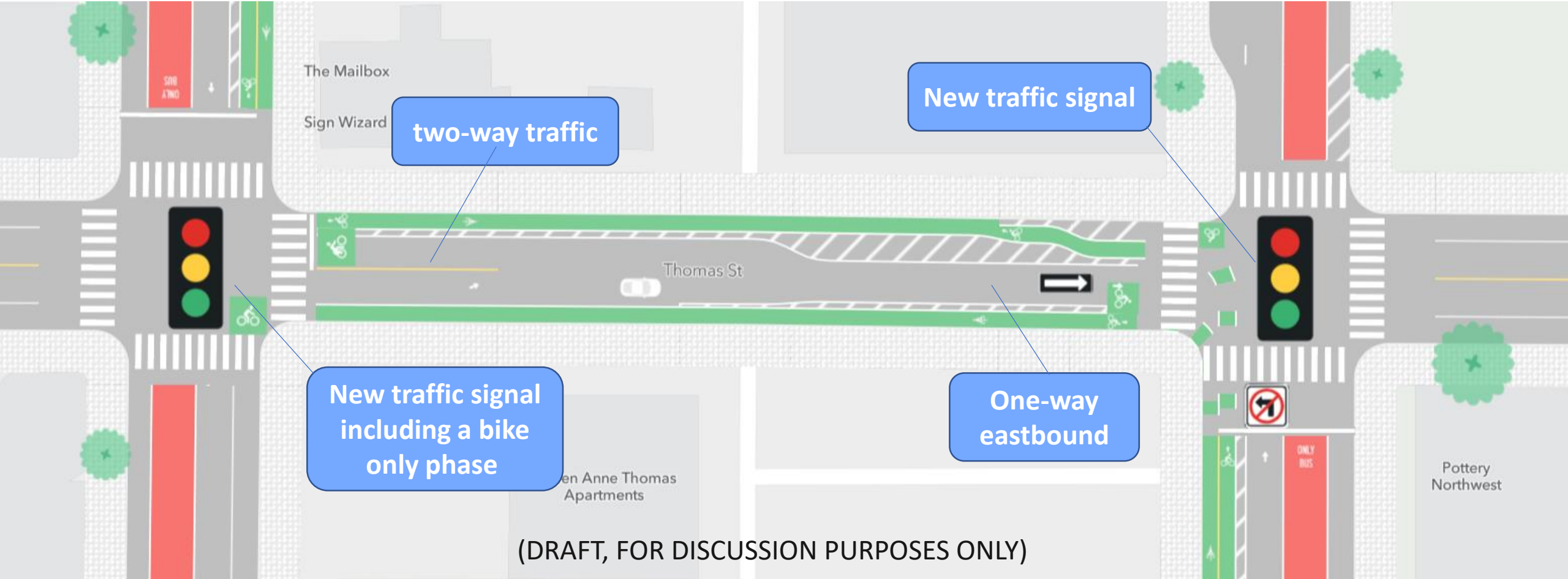

2nd Ave and Denny Way Intersection

- Need to accommodate two 10' southbound travel lanes along 2nd Ave south of Denny Way
- Existing channelization and right-of-way shown

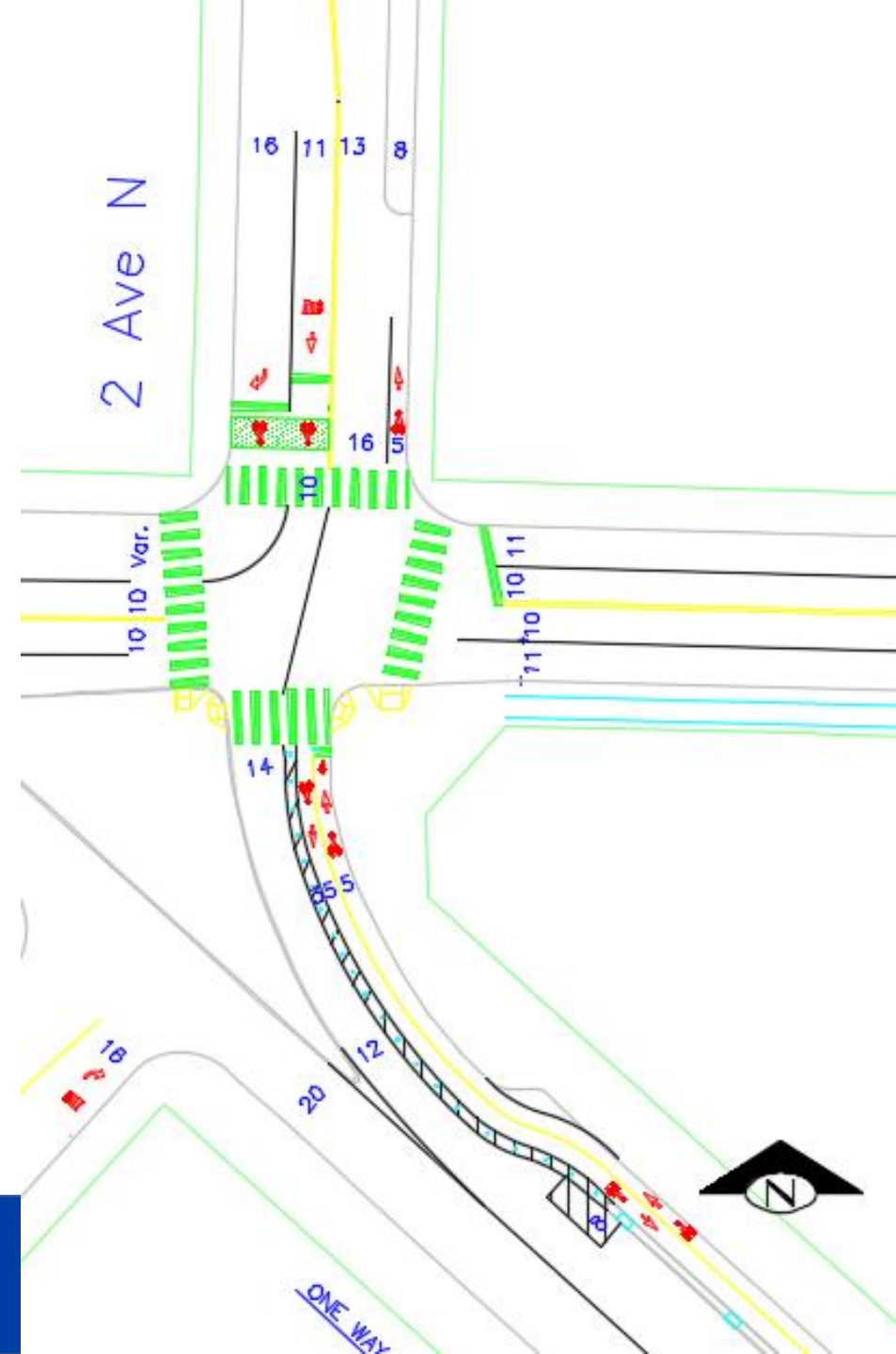

2nd Ave and Denny Way Intersection

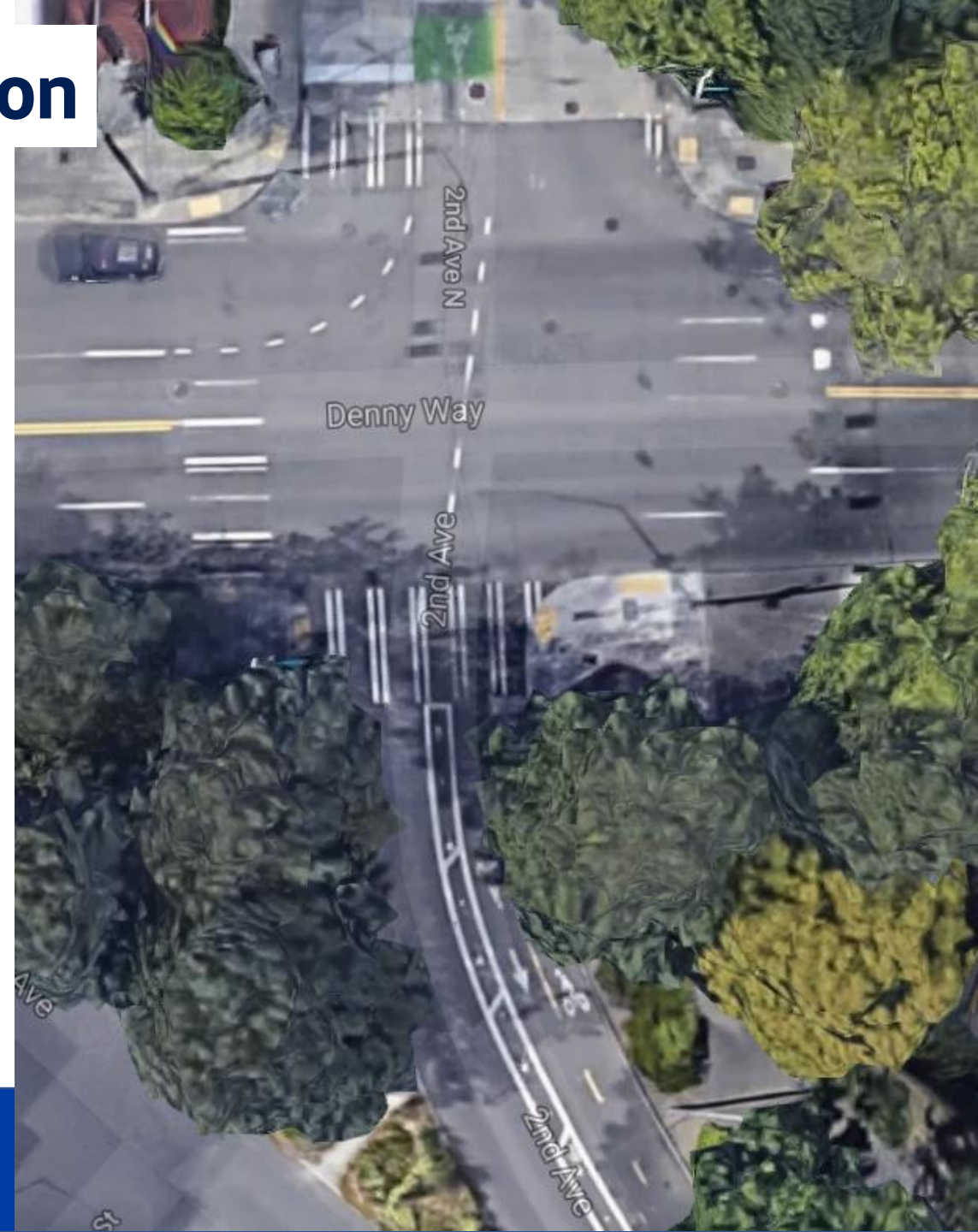
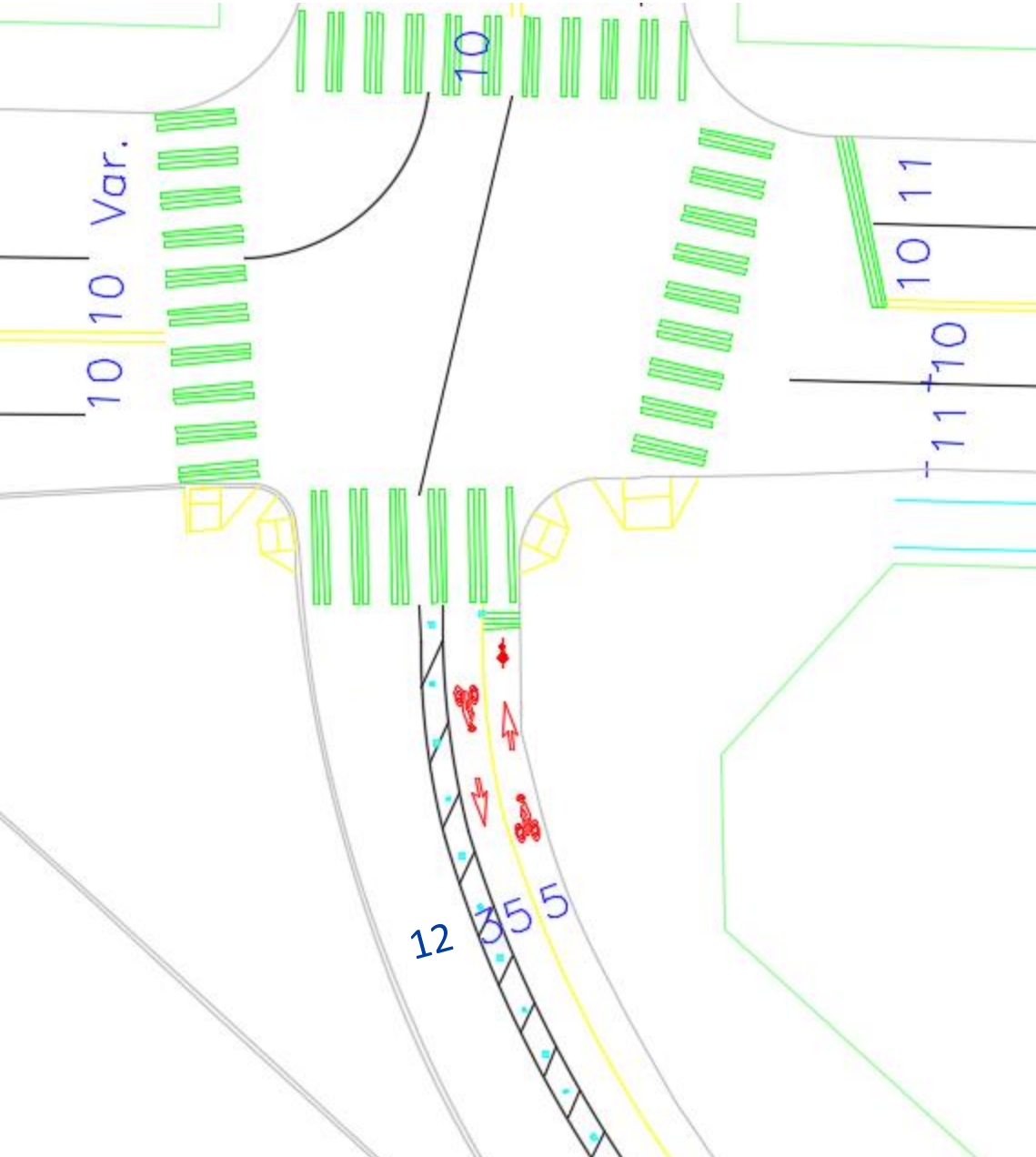

Questions?

www.seattle.gov/transportation

